

±18,960 SF INDUSTRIAL BUILDING

# FOR SUBLEASE

18528 Dominguez Hills Dr

Rancho Dominguez, CA 90220

**LEE & ASSOCIATES**  
COMMERCIAL REAL ESTATE SERVICES

PAULHAN ST

S DOMINGUEZ HILLS DR

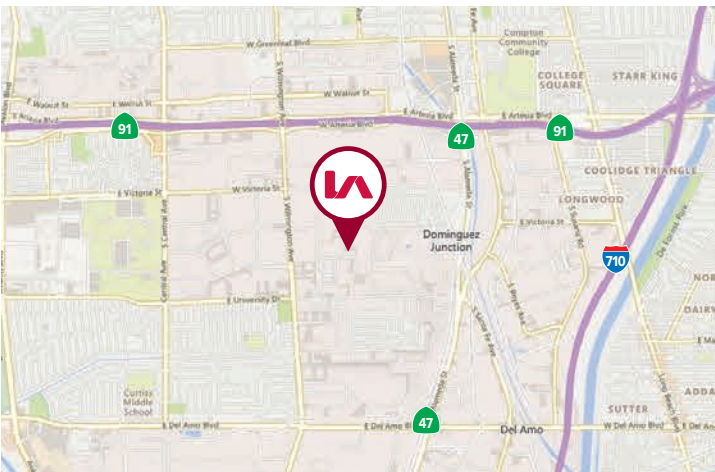

## PROPERTY HIGHLIGHTS

- Unincorporated LA County
- 2 Dock High Positions
- 24' Clear Height
- Gated Yard
- Sublease Through 5/31/2028

ASKING RATE

TBD

FOR MORE INFORMATION, PLEASE CONTACT

**SAM RINKOV**

LIC NO 02132512

[srinkov@lee-associates.com](mailto:srinkov@lee-associates.com)

818.324.4329

**JEFFREY RINKOV**

CEO | LIC NO 01238887

[jrinkov@lee-associates.com](mailto:jrinkov@lee-associates.com)

213.400.7941

**ETHAN RINKOV**

LIC NO 02253349

[erinkov@lee-associates.com](mailto:erinkov@lee-associates.com)

818.325.5175

The information has been furnished from sources which we deem reliable, but for which we assume no liability. Any projections, opinions, assumptions or estimates used are for example only and do not represent the current or future performance of the property. Buyers should consult with their independent advisors to determine if the property is suitable for their needs.



±18,960 SF INDUSTRIAL BUILDING

# FOR SUBLEASE

18528 Dominguez Hills Dr

Rancho Dominguez, CA 90220

## PROPERTY SITE PLAN

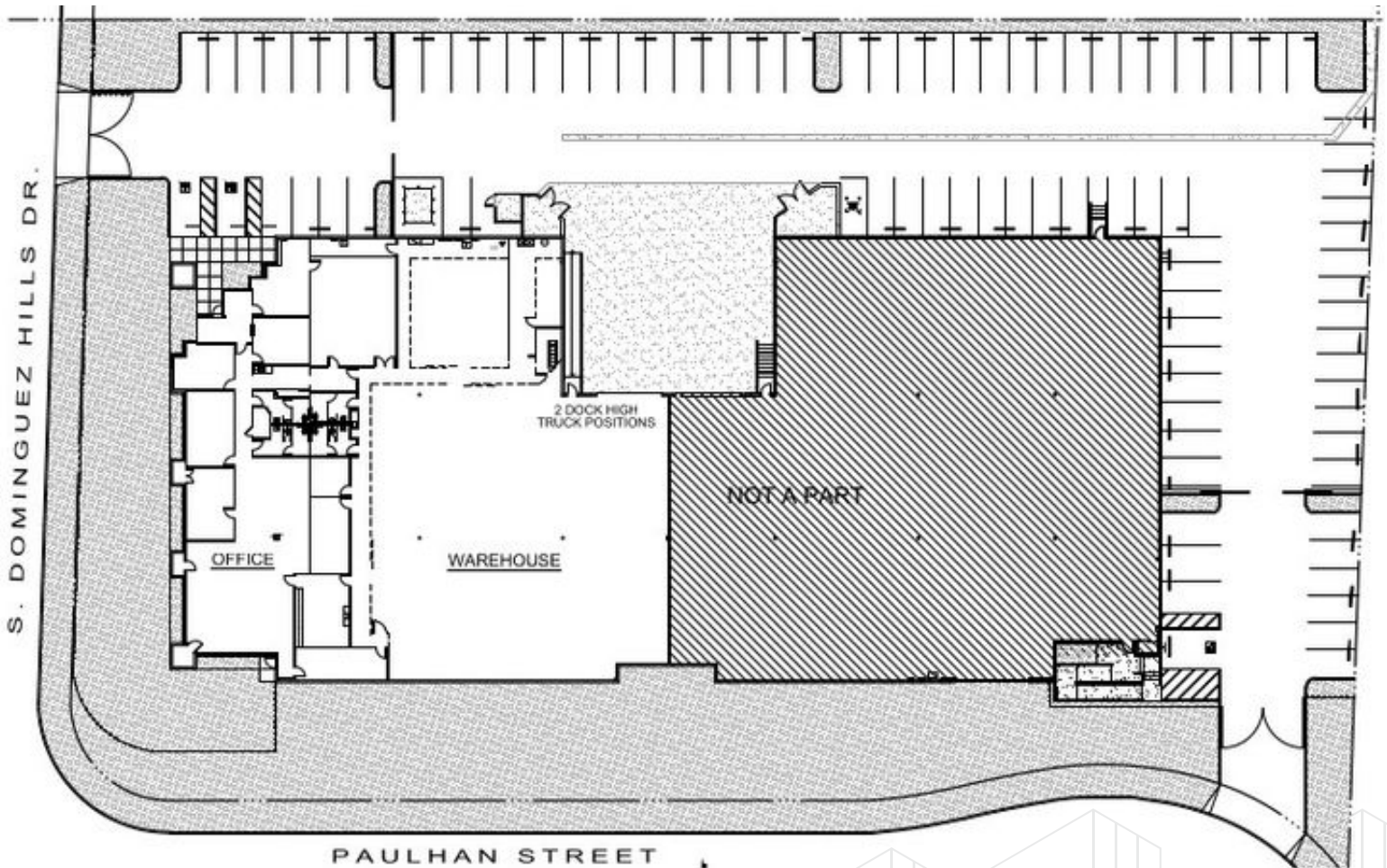

NOTE: Drawing not to scale. All measurements and sizes are approximate. Lessee to Verify

FOR MORE INFORMATION, PLEASE CONTACT

### SAM RINKOV

LIC NO 02132512

[srinkov@lee-associates.com](mailto:srinkov@lee-associates.com)

818.324.4329

### JEFFREY RINKOV

CEO | LIC NO 01238887

[jrinkov@lee-associates.com](mailto:jrinkov@lee-associates.com)

213.400.7941

### ETHAN RINKOV

LIC NO 02253349

[erinkov@lee-associates.com](mailto:erinkov@lee-associates.com)

818.325.5175

The information has been furnished from sources which we deem reliable, but for which we assume no liability. Any projections, opinions, assumptions or estimates used are for example only and do not represent the current or future performance of the property. Buyers should consult with their independent advisors to determine if the property is suitable for their needs.