

FOR LEASE OR SALE

51,840 SF- BUILDING 1



M380 BUSINESS PARK

2075 N Masch Branch Road | Denton, TX 76207

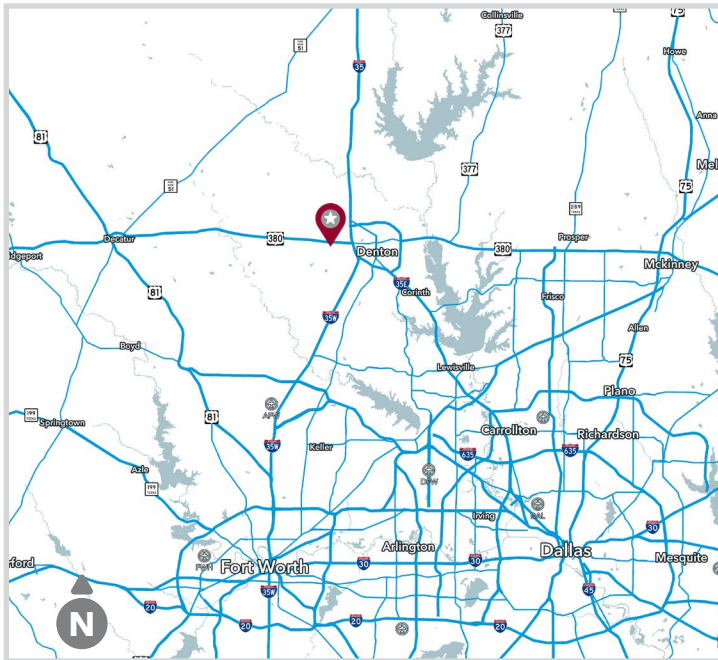

AVAILABILITY HIGHLIGHTS

- 51,840 SF divisible to $\pm 25,920$ SF or $\pm 17,089$ SF
- 2,393 SF Spec Office
- Clear Height 28'
- 16 Dock High Doors
- 72 Car Parks
- 10 Service Truck Spaces
- 120' Truck Court
- ESFR Sprinkler System
- 21,500 SF of Potential Outside Storage
- White-boxed Warehouse with LED Lighting
- Move-in Ready
- [Click here for Video](#)

FOR LEASING INFORMATION:

Adam Graham, SIOR, CCIM
agraham@lee-associates.com
214.335.3320

Chris Beggins
cbeggins@lee-associates.com
972.934.4032

DEVELOPED BY:



LEASING:



51,840 SF

FOR LEASE OR SALE

SITE PLAN

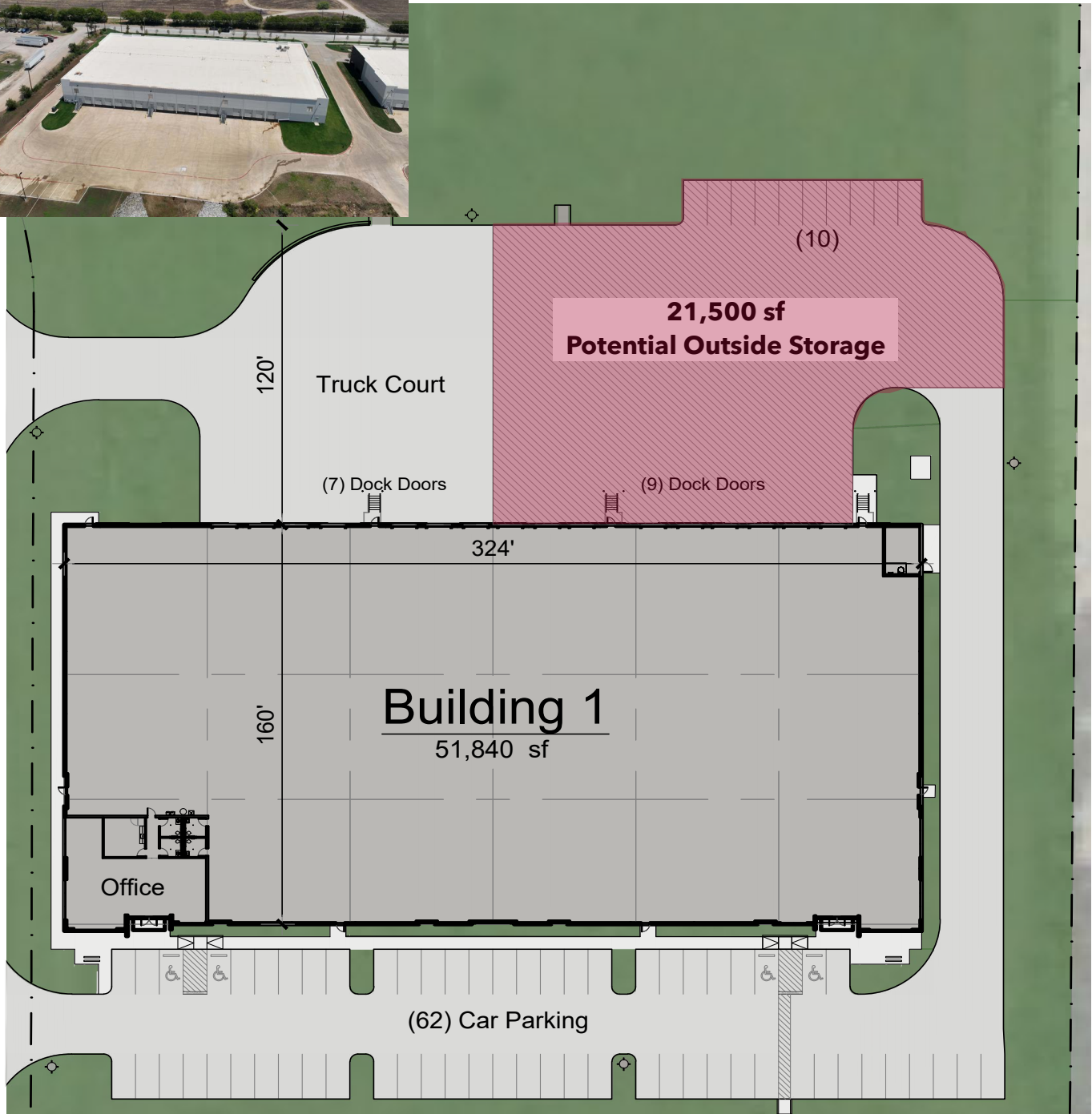

FOR LEASING INFORMATION:

Adam Graham, SIOR, CCIM
agraham@lee-associates.com
214.335.3320

Chris Beggins
cbeggins@lee-associates.com
972.934.4032

DEVELOPED BY:

 **BOX
INVESTMENT
GROUP**

LEASING:

 **LEE &
ASSOCIATES**
COMMERCIAL REAL ESTATE SERVICES