



**M c K I N N E Y
L O G I S T I C S
P A R K**

FOR LEASE
BUILDING 3
52,098 SF AVAILABLE



McKINNEY LOGISTICS PARK

BUILDING 3 | 620 MCINTYRE ROAD | MCKINNEY, TX 75071

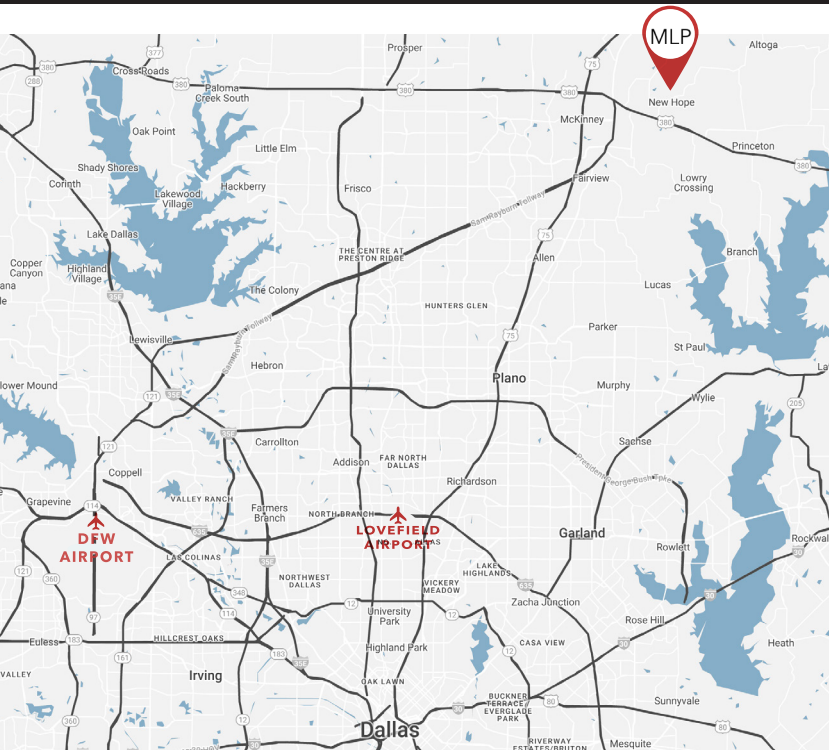

PROJECT HIGHLIGHTS

- Available Space: 52,098 SF
- Office: ± 1,996 SF
- Clear Height: 32'
- Dock Doors: 10 Dock High (5 outfitted with 40,000lb Pneumatic Airbag Levelers)
- Ramps: 1 (12' x 14')
- Building Depth: 240'
- Column Spacing: 60' x 54' (60' Speed Bay)
- Trailer Stalls: Approximately 14 Dedicated
- Sprinkler: ESFR
- Move-In Ready
- Whiteboxed Warehouse with LED Lighting (25' FC)

FOR LEASING INFORMATION:



Ken Wesson, SIOR, CCIM
kwesson@lee-associates.com
C: 469 855 5222

Adam Graham, SIOR, CCIM
agraham@lee-associates.com
C: 214.335.3320

DEVELOPED AND MANAGED BY:



FLOOR PLAN

BUILDING 3 AVAILABILITY

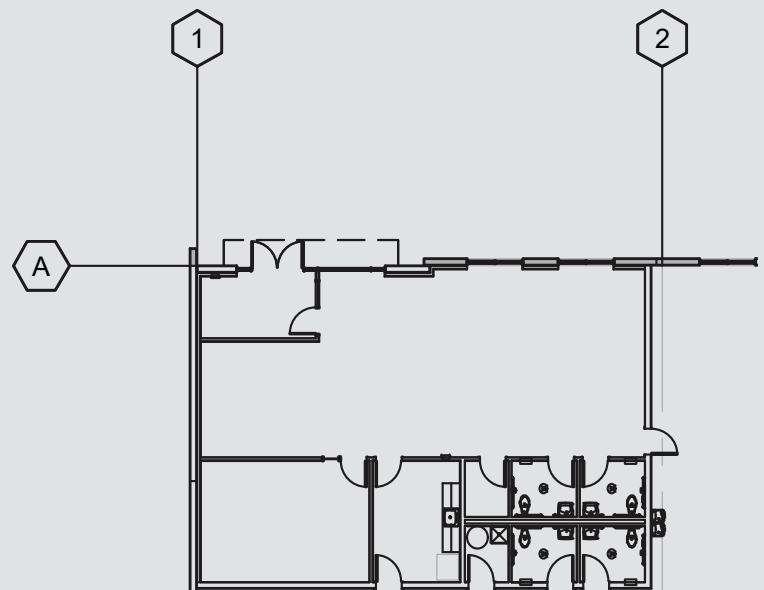

FOR LEASING INFORMATION:



Ken Wesson, SIOR, CCIM
kwesson@lee-associates.com
C: 469.855.5222

Adam Graham, SIOR, CCIM
agraham@lee-associates.com
C: 214.335.3320

DEVELOPED AND MANAGED BY:

