

FOR LEASE

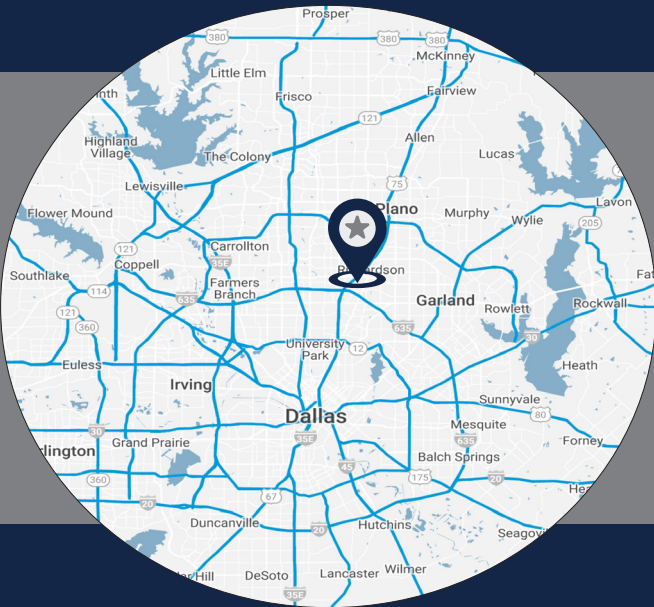

TI BUSINESS PARK

1400 S SHERMAN ST & 1351 TI BLVD | RICHARDSON, TX 75081



LISTING HIGHLIGHTS

ADDRESS:	1400 S Sherman St, 1351 TI Blvd
AVAILABLE SF:	+/- 100,206 SF
YEAR BUILT:	1981
PARKING:	233 Parking spaces
NOTES:	<ul style="list-style-type: none">• Three buildings• Easy access to Central Expressway and Hwy 635

FOR LEASING INFORMATION:

Jessica Reinhardt

jreinhardt@lee-associates.com

972.934.4005

972.891.5236

Susan Cancemi

scancemi@lee-associates.com

972.934.4005

469.236.3386

OWNED BY:



LEASED BY:



1351 TI BLVD

FOR LEASE

SUITE 105

3,109 SF

- 1 Grade level door

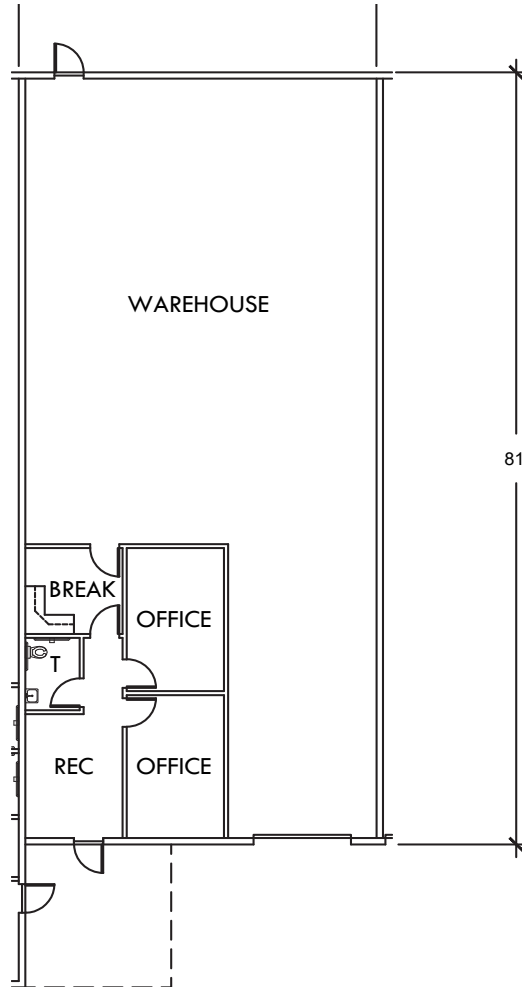

SITE PLAN

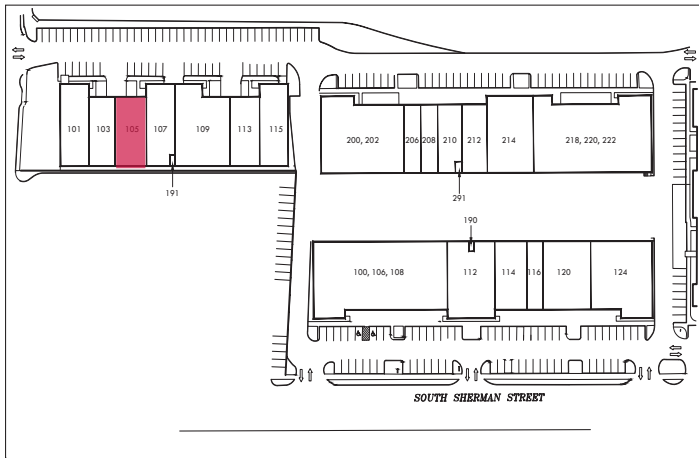

AERIAL

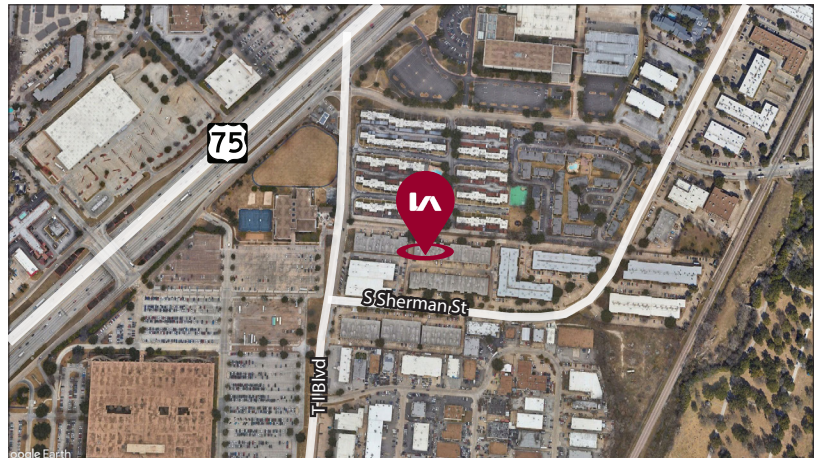

All information furnished regarding property for sale, rental or financing is from sources deemed reliable, but no warranty or representation is made to the accuracy thereof and same is submitted to errors, omissions, change of price, rental or other conditions prior to sale, lease or financing or withdrawal without notice. No liability of any kind is to be imposed on the broker herein.

Jessica Reinhardt

jreinhardt@lee-associates.com

972.934.4005

972.891.5236

Susan Cancemi

scancemi@lee-associates.com

972.934.4005

469.236.3386

OWNED BY:



LEASED BY:

