

# FOR LEASE

## 6,342 SF



### 1240 TEXAN TRAIL, SUITE 106

GRAPEVINE, TX 76051

## AVAILABILITY HIGHLIGHTS

- ±6,342 SF
- ±2,270 SF Office
- 7 Dock High Doors, 1 Ramp
- 16' Clear Height
- Not Sprinklered
- Available 8/1/26

## ECONOMICS

Contact Broker for Pricing; OPEX \$2.14/psf

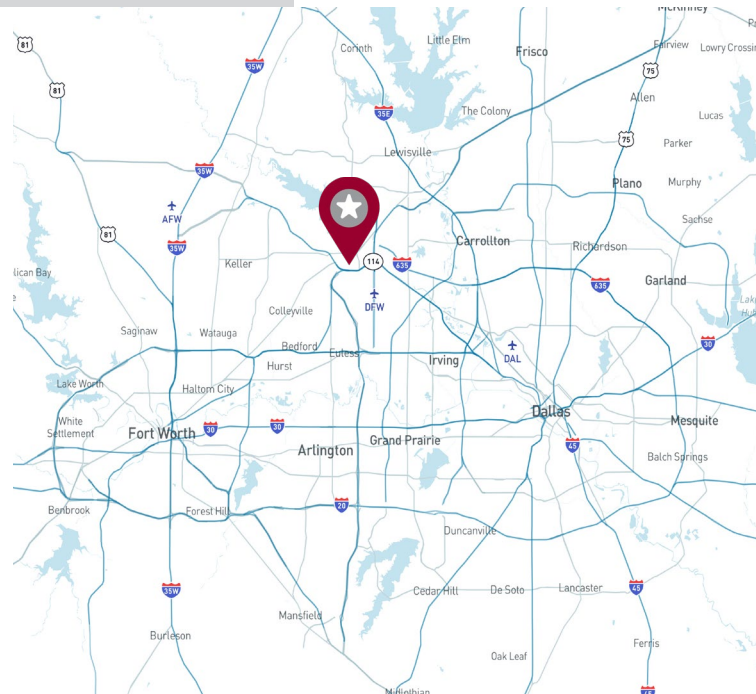

FOR LEASING INFORMATION:

**Chris Hillman**  
214.797.2451  
chillman@lee-associates.com

**Phil Rosenfeld**  
469.222.4159  
prosenfeld@lee-associates.com

**LEE & ASSOCIATES**  
COMMERCIAL REAL ESTATE SERVICES

leedallas.com

## FLOOR PLAN

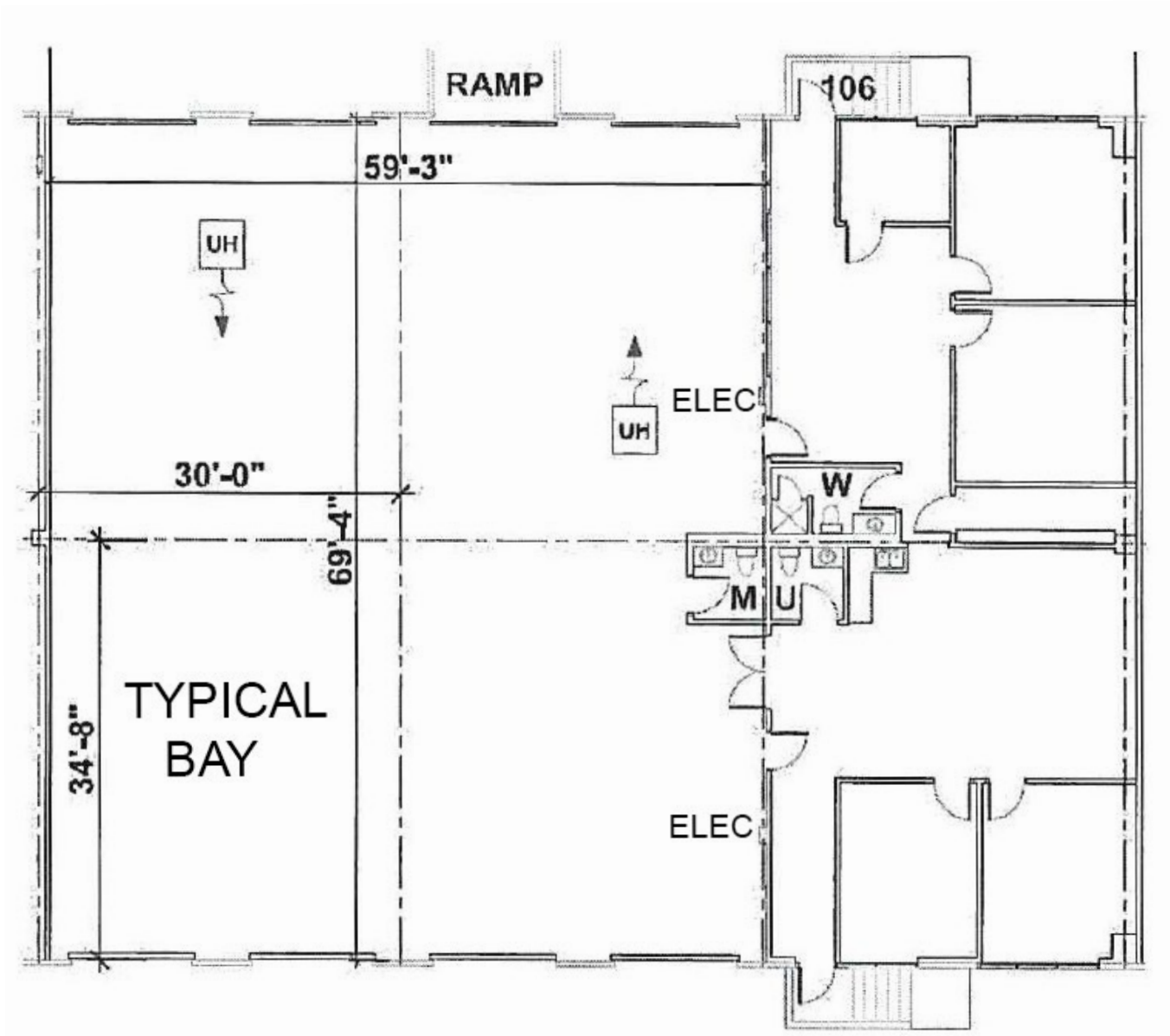

All information furnished regarding property for sale, rental or financing is from sources deemed reliable, but no warranty or representation is made to the accuracy thereof and same is submitted to errors, omissions, change of price, rental or other conditions prior to sale, lease or financing or withdrawal without notice. No liability of any kind is to be imposed on the broker herein.

### FOR LEASING INFORMATION:

**Chris Hillman**  
214.797.2451  
chillman@lee-associates.com

**Phil Rosenfeld**  
469.222.4159  
prosenfeld@lee-associates.com