

44,167 SF

9755 Clifford Street, Suite 100
Dallas, TX 75220

Prologis Stemmons 21

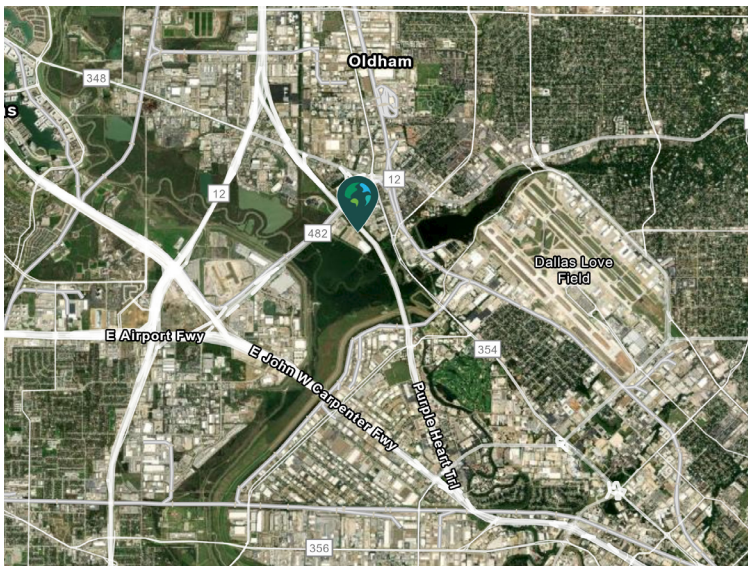

- Easy access to major thoroughfares including I-35E, SH 183, SH 114, and TX-12
- Approximately 4 miles to Dallas Love Field Airport

Property Features

Available Space	44,167 SF
Office SF	5,003 SF
Clear Height	23'
Column Spacing	40' x 44'
Dock Doors	7 (8' x 10')
Drive-in Doors	1 (8' x 10')
Dock Levelers	6
Car Parking Spaces	142
Electrical Service	800 amps
Sprinklered	Yes
Truck Court	118'



Unlock the full potential of your warehouse with one strategic, single-source partner.

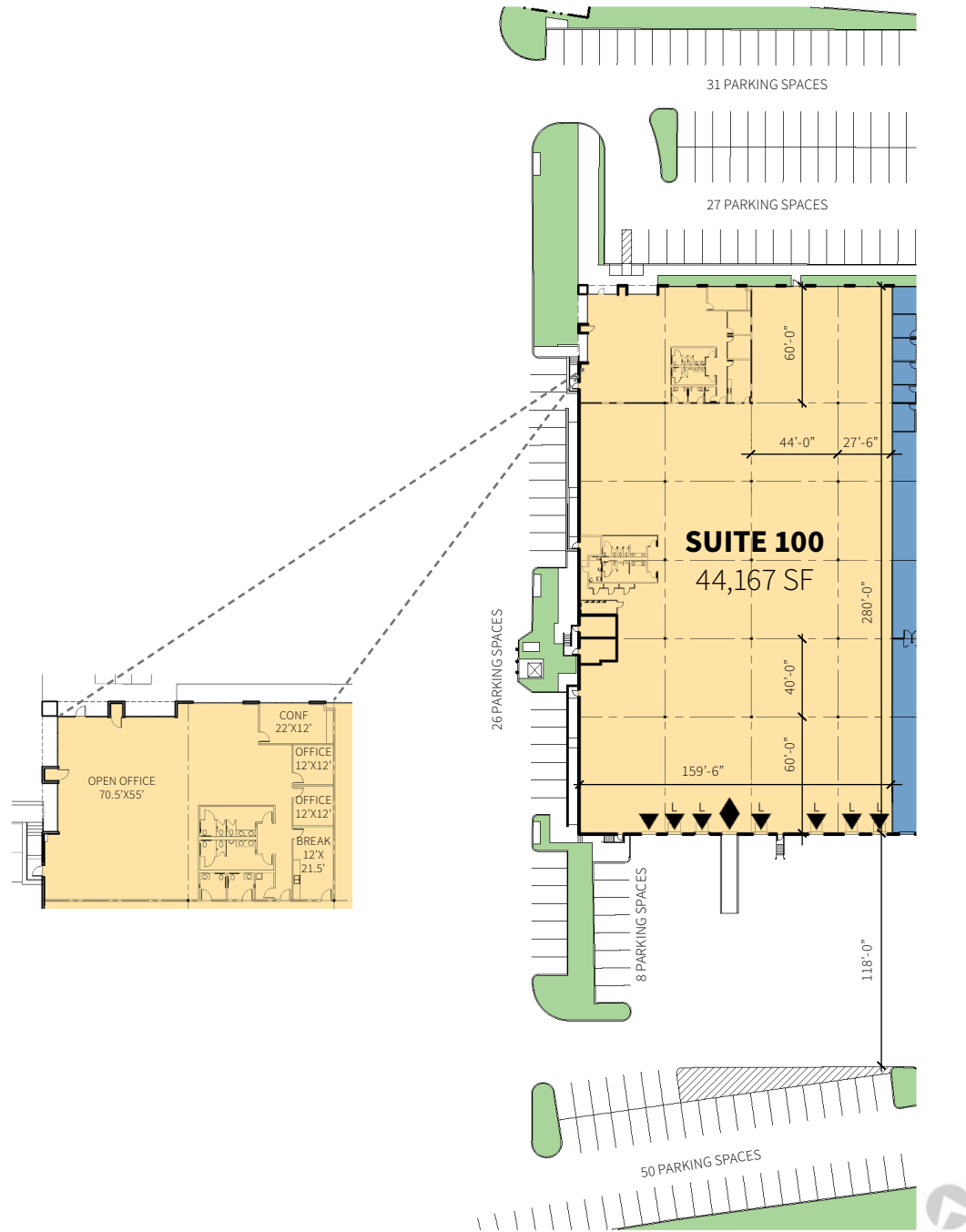

Lee & Associates
Adam Graham, SIOR
 agraham@lee-associates.com
 ph +1 972 934 4011
 cell +1 214 335 3320

Lee & Associates
Stephen Williamson, SIOR
 swilliamson@lee-associates.com
 ph +1 972 934 4045
 cell +1 817 705 5470

Prologis
Kathleen Isola
 ksiola@prologis.com
 ph +1 972 884 9202
 cell +1 214 709 1405
 prologis.com