

2306 LAS POSAS ROAD

CAMARILLO
CA 93010

2306 LAS
POSAS RDC

LAS POSAS ROAD

CAMARILLO
VILLAGE SQUARE



FOR SUBLEASE

Prominent corner pad/building
located at the southeast corner
of Las Posas Rd. & Arneill Rd.

LISA SHIELDS
805.879.9639
lsields@radiusgroup.com

CA LIC. 01742786

© 1/6/25 Radius Group Commercial Real Estate, Inc. DRE lic. 01334755. All rights reserved. Content and/or images may not be used without permission.
The information provided here has been obtained from the owner of the property or from other sources deemed reliable. We have no reason to doubt its accuracy, but we do not guarantee it.



RADIUSGROUP.COM

±3,072SF CORNER MEDICAL/RETAIL SPACE

2306 LAS POSAS RD • UNIT C • CAMARILLO, CA • 93010



Property Highlights

- 2nd Generation Urgent Care space available now. Space is located on an end cap pad position adjacent to Starbucks, with access along Las Posas Road.
- Pad is near the Sprouts grocery anchored shopping center, Camarillo Village Square.
- Every interior detail has been carefully considered to support the unique needs of an urgent care facility. Layout includes 5 exam rooms, imaging room (X-ray available w/sublease), lab space, break room, two ADA restrooms (one is DOT certified), and reception. The space is optimized for medical care.

Nearby Tenants:



LISA SHIELDS

805.879.9639

lsields@radiusgroup.com

CA LIC. 01742786

© 1/6/25 Radius Group Commercial Real Estate, Inc. DRE lic. 01334755. All rights reserved. Content and/or images may not be used without permission. The information provided here has been obtained from the owner of the property or from other sources deemed reliable. We have no reason to doubt its accuracy, but we do not guarantee it.

SUBLEASE

Prominent corner pad/building located at the southeast corner of Las Posas Rd. & Arneill Rd.

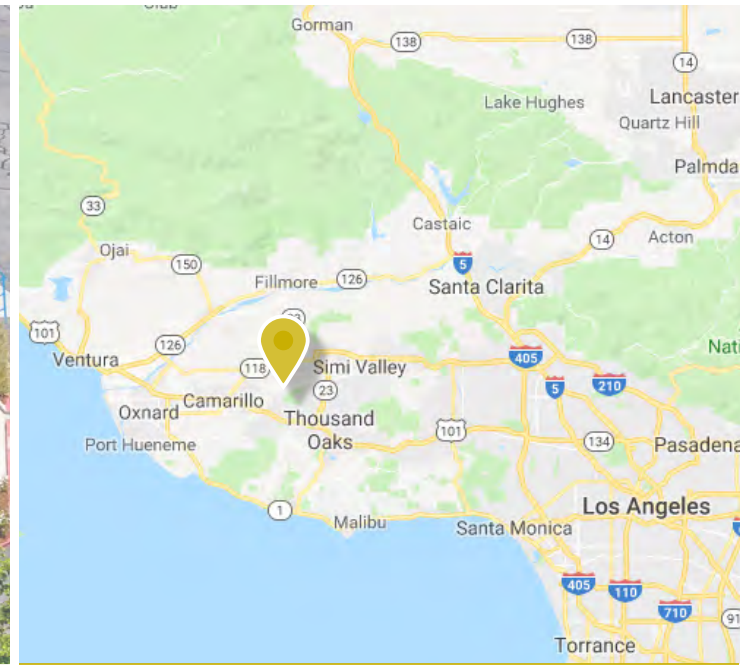

Opportunity Highlights

Type	2nd Generation Urgent Care/Retail
Reduced Sublease Rate	\$2.75/SF + NNN Per SF
Available	Now
Term	Through 9/30/2030
Parking	Four (4) Exclusive Spaces + In-common
HVAC	Yes
Restrooms	Two (2) ADA



RADIUSGROUP.COM

±3,072SF CORNER MEDICAL/RETAIL SPACE

2306 LAS POSAS RD · UNIT C · CAMARILLO, CA · 93010

SUBLEASE

Prominent corner pad/building located at the southeast corner of Las Posas Rd. & Arneill Rd.

SUITE C | FLOORPLAN

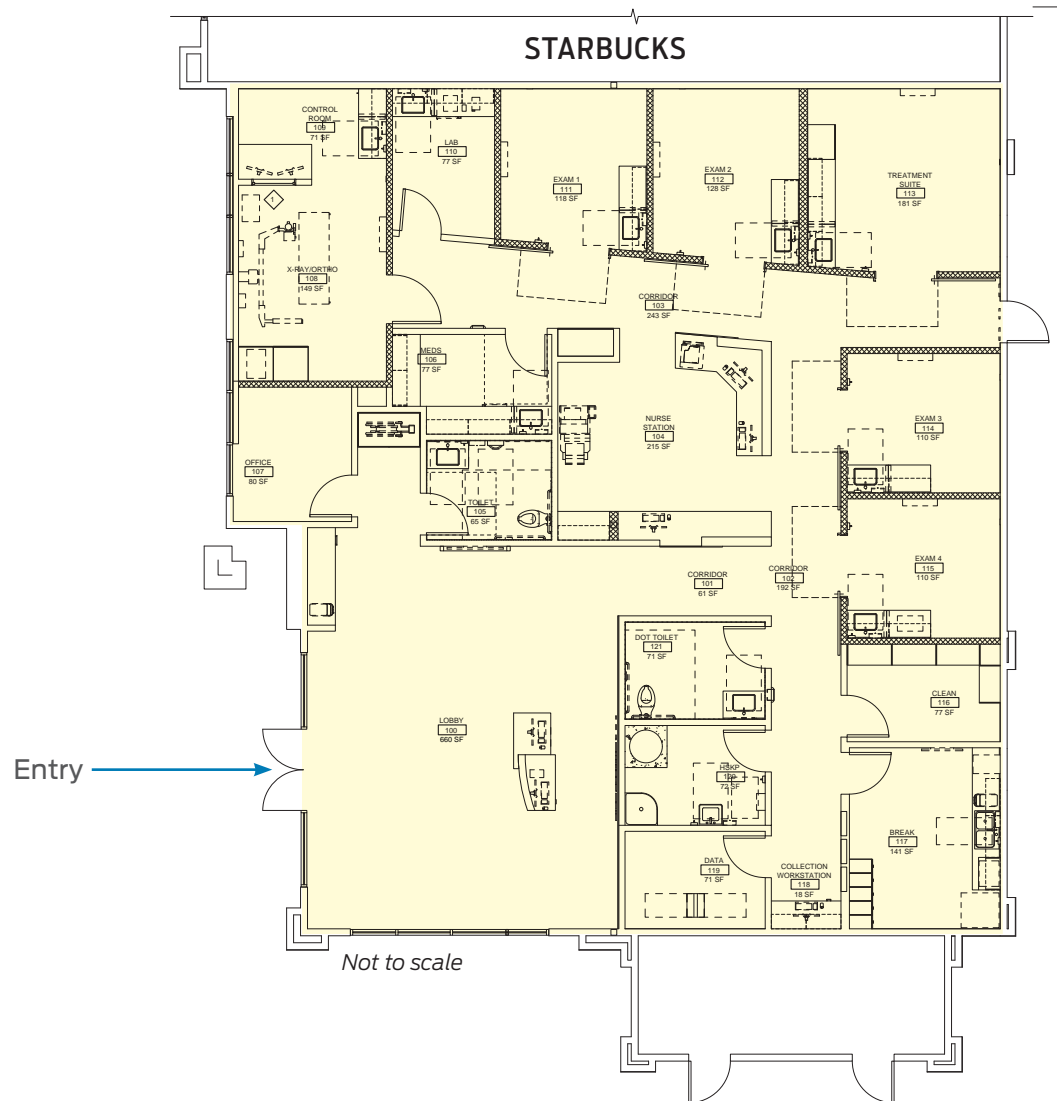

LISA SHIELDS
805.879.9639
lsbiields@radiusgroup.com

CA LIC. 01742786

© 1/6/25 Radius Group Commercial Real Estate, Inc. DRE lic. 01334755. All rights reserved. Content and/or images may not be used without permission. The information provided here has been obtained from the owner of the property or from other sources deemed reliable. We have no reason to doubt its accuracy, but we do not guarantee it.



RADIUSGROUP.COM

±3,072SF CORNER MEDICAL/RETAIL SPACE

2306 LAS POSAS RD • UNIT C • CAMARILLO, CA • 93010

SUBLEASE

Prominent corner pad/building located at the southeast corner of Las Posas Rd. & Arneill Rd.



LISA SHIELDS
805.879.9639
lsields@radiusgroup.com

CA LIC. 01742786

© 1/6/25 Radius Group Commercial Real Estate, Inc. DRE lic. 01334755. All rights reserved. Content and/or images may not be used without permission. The information provided here has been obtained from the owner of the property or from other sources deemed reliable. We have no reason to doubt its accuracy, but we do not guarantee it.



RADIUSGROUP.COM